

# S Series Slide Switches

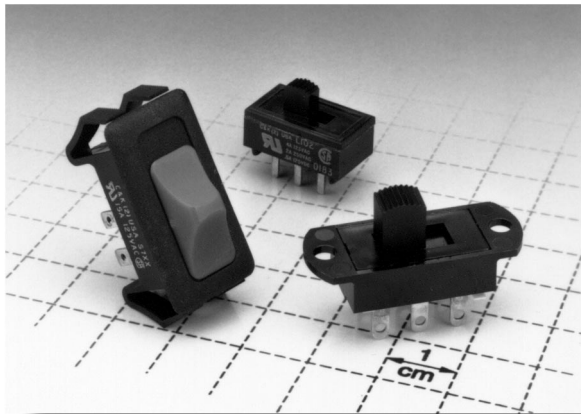

## Features/Benefits

- 6 to 15 AMPS
- Enclosed housing
- PC and Snap-in panel mounting
- Reversing option

## Typical Applications

- Portable tools
- Small appliances
- Floor care products

## Build-A-Switch

Our easy Build-A-Switch concept allows you to mix and match options to create the switch you need. Below is a complete listing of options shown in catalog. To order, simply select desired option from each category and place in the appropriate box. Switches with standard options are shown on page E-31. Available options are shown and described on pages E-32 thru E-35. For additional options not shown in catalog, consult Customer Service Center.

Typical Example: S 1 0 1 — 0 3 — 1 — S S — 0 3 —   — Q —  

### Switch Function

- S101** (STD.) SPST, 6 AMPS
- S202** (STD.) DPDT, 6 AMPS
- S802** (STD.) DPDT, 15 AMPS
- S102** SPDT, 6 AMPS
- S111** SPST, mom., 6 AMPS
- S112** SPDT, mom., 6 AMPS
- S201** DPST, 6 AMPS
- S501** SPST, 12 AMPS
- S502** SPDT, 12 AMPS
- S511** SPST, mom., 12 AMPS
- S512** SPDT, mom., 12 AMPS
- S601** DPST, 12 AMPS
- S602** DPDT, 12 AMPS
- S701** SPST, 15 AMPS
- S702** SPDT, 15 AMPS
- S711** SPST, mom., 15 AMPS
- S712** SPDT, mom., 15 AMPS
- S801** DPST, 15 AMPS

### Actuator

- 03** (STD.) .335" high
- 04** .500" high
- 09** .250" high
- 12** Screwdriver slot (with marking)
- 13** Screwdriver slot (without marking)
- C1** White snap-on cap
- C2** Black cap
- C3** Red cap
- CT** Beige cap

### Detent

- 1** (STD.) With detent
- 2** (STD.) Without detent

### Mounting Style

- SS** (STD.) Panel with mounting ears
- MS** PC thru-hole
- S1** Snap-in panel
- S2** Snap-in panel
- S3** Snap-in panel
- ST** Snap-in panel

### Terminations

- 03** (STD.) Solder lug with hole
- 01** Solder lug with notch
- 02** PC Thru-hole
- 04** PC Thru-hole
- 07** Quick connect
- 08** PC Thru-hole
- 51** Reversing feature
- 52** Reversing feature
- 53** Reversing feature
- 54** Reversing feature
- 57** Reversing feature
- WC** Wire lead
- WR** Reversing feature

### Housing Markings

- NONE** (STD.) No markings
- D** ON-OFF
- L** ON
- M** ON-OFF
- N** Red rectangle on one end

### Contact Material

- Q** (STD.) Silver
- B** Gold
- G** Gold over silver

### Seal

- NONE** (STD.) No seal
- E** Epoxy seal



## Specifications

**CONTACT RATING:** Q contact material (S1XX, S2XX Models):  
6 AMPS @ 125 V AC; 6 AMPS @ 250 V AC; 1 AMP @  
125 V DC (UL/CSA). (S5XX, S6XX Models): 12 AMPS @  
125 V AC; 6 AMPS @ 250 V AC; 1 AMP @ 125 V DC (UL/CSA).  
(S7XX, S8XX Models): 15 AMPS @ 125 V AC; 6 AMPS @  
250 V AC (UL/CSA). See page E-35 for additional ratings.

**ELECTRICAL LIFE:** 10,000 make-and-break cycles at full load.

**CONTACT RESISTANCE:** Below 10 milliohms typ. initial  
@ 2-4 V DC, 100 mA, for both silver and gold plated contacts.

**INSULATION RESISTANCE:** 10<sup>9</sup> ohms min.

**DIELECTRIC STRENGTH:** 1,000 V RMS min. @ sea level.

## Materials

**HOUSING:** 6/6 nylon (UL94V-2), black.

**TOP PLATE:** 6/6 nylon (UL94V-2), black.

**ACTUATOR:** 6/6 nylon (UL94V-2), black (standard).

**CONTACTS:** Q contact material: Copper, silver plated. See page E-35 for additional contact materials.

**TERMINALS:** Q contact material: Copper, silver plated. See page E-35 for additional contact materials.

**CONTACT SPRING:** Music wire or stainless steel.

**TERMINAL SEAL:** Epoxy.

**NOTE:** Specifications and materials listed above are for switches with standard options. For information on specific and custom switches, consult Customer Service Center.

## SWITCHES WITH STANDARD OPTIONS

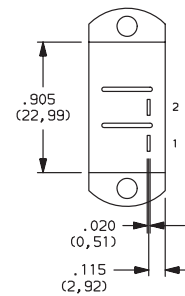
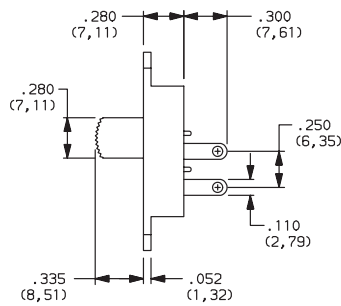
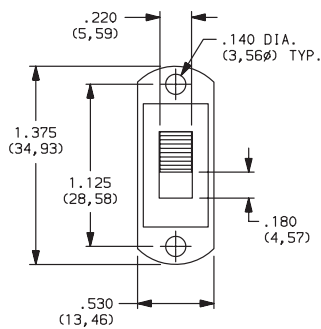

TERM. NOS. FOR  
REFERENCE ONLY



S101031SS03Q  
SPST

PART NUMBER	FUNCTION	AMP RATING
<b>S101031SS03Q</b>	SPST	6

NOTE: For panel mounting information, see page E-33.

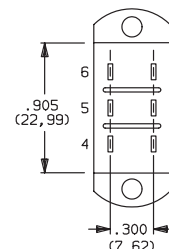
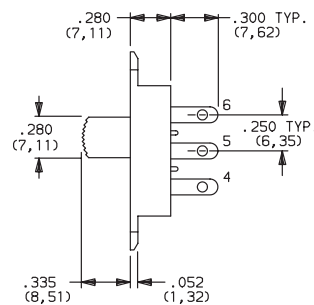
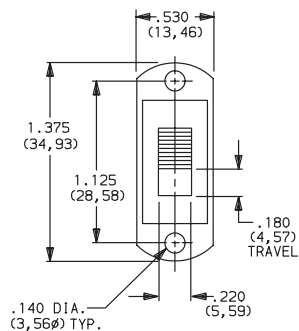

TERM. NOS. FOR  
REFERENCE ONLY



S202031SS03Q  
DPDT

PART NUMBER	FUNCTION	AMP RATING
<b>S202031SS03Q</b>	DPDT	6

NOTE: For panel mounting information, see page E-33.

# S Series Slide Switches



## SWITCH FUNCTION

NO. POLES	MODEL NO.	AMP RATING	SWITCH FUNCTION	SCHEMATIC	AVAILABLE MOUNTING STYLES
SP	<b>S101 (STD.)</b>	6	SPST		MM,SS
	<b>S102</b>	6	SPDT		MS
	<b>S111</b>	6	SPST-MOM.		MS
	<b>S112</b>	6	SPDT-MOM.		MS,SS
	<b>S501</b>	12	SPST		MS,SS
	<b>S502</b>	12	SPDT		MS,SS
	<b>S511</b>	12	SPST-MOM.		MS,SS
	<b>S512</b>	12	SPDT-MOM.		MS,SS
	<b>S701</b>	15	SPST		S1, S2, S3, ST
	<b>S702</b>	15	SPDT		S1, S2, S3, ST
	<b>S711</b>	15	SPST-MOM.		S1, S2, S3, ST
	<b>S712</b>	15	SPDT-MOM.		S1, S2, S3, ST

NO. POLES	MODEL NO.	AMP RATING	SWITCH FUNCTION	SCHEMATIC	AVAILABLE MOUNTING STYLES
DP	<b>S201</b>	6	DPST		MS,SS
	<b>S202 (STD.)</b>	6	DPDT		MS,SS
	<b>S601</b>	12	DPST		MS,SS
	<b>S602</b>	12	DPDT		MS,SS
	<b>S801</b>	15	DPST		S1, S2, S3, ST
	<b>S802 (STD.)</b>	15	DPDT		S1, S2, S3, ST

NOTE: and MOM. in table indicates momentary action.

All models with all options when ordered with 'G' or 'Q' contact material.

Contacts make on side actuator thrown.

## ACTUATOR

**03 (STD.)** .335" HIGH

**04** .500" HIGH

**09** .250" HIGH

**12** SCREWDRIVER SLOT (WITH MARKING)

**13** SCREWDRIVER SLOT (WITHOUT MARKING)

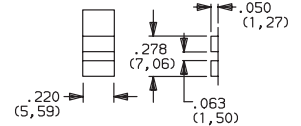
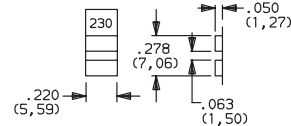
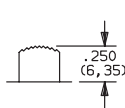
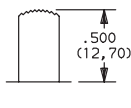
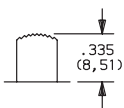

White 115-230 markings (std.).

Without markings.

NOTE: Standard actuator color is black, other colors available, consult Customer Service Center. Alternate heights are available with '03, 04, 09 and 10' actuators, consult Customer Service Center. Models with 'S1, S2, S3 and ST' mounting style, subtract .090 (2,29). Actuators '12' and '13' are available with DPST and DPDT models only.

### C1-CT SNAP-ON CAP

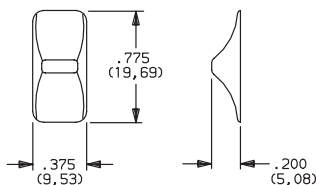

Available with 'S1, S2, S3 and ST' mounting style only.

OPTION CODE2	C1-CT CAP COLOR
<b>C2</b>	(STD.) BLACK
<b>C1</b>	WHITE
<b>C3</b>	RED
<b>CT</b>	BEIGE

NOTE: Actuator finish: matte. If no color is specified, black will be supplied. Colored actuator caps may also be ordered separately and user installed, see page L-9.

## DETENT

**1 (STD.) WITH DETENT**

Standard with all maintained models: S101, S102, S103, S202, S203, S501, S502, S601, S602, S701, S702, S801 and S802.

**2 (STD.) WITHOUT DETENT**

Standard with all momentary models: S111, S112, S511, S512, S711 and S712.



# S Series Slide Switches

## MOUNTING STYLE

### SS (STD.) PANEL WITH MOUNTING EARS

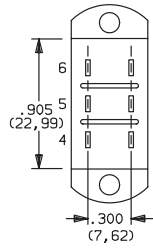
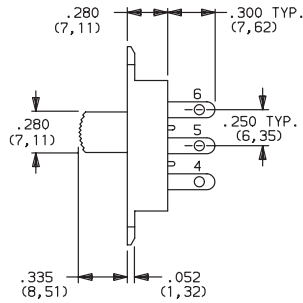
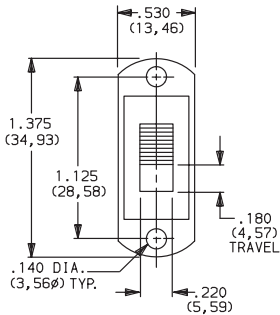

#### PANEL MOUNTING

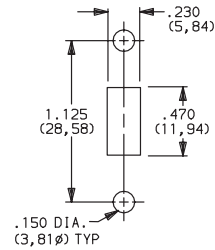

S202031SS03Q  
DPDT

#### AVAILABLE WITH:

**Models:** S101, S102, S111, S112, S201, S202, S501, S502, S511, S512, S601 and S602  
**Terminations:** All except 08  
**Actuators:** 03, 04, 09, 10, 12\* and 13\*

\*12 and 13 actuators not available with S1XX models.

### MS PC THRU-HOLE

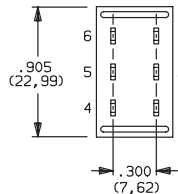
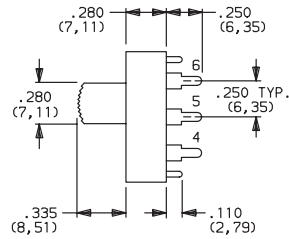
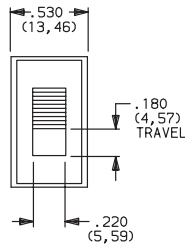

#### AVAILABLE WITH:

**Models:** S101, S111, S102, S112, S201, S202.  
**Terminations:** 02, 04, 08, 52 and 54  
**Actuators:** 03, 04, 09, 10, 12\* and 13\*

\*12 and 13 actuators available with S201, S202, S601 and S602 models only.

#### PC MOUNTING

For mounting information, see TERMINATIONS section, page E-34.



S202031MS02Q  
DPDT

### S1-ST SNAP-IN PANEL

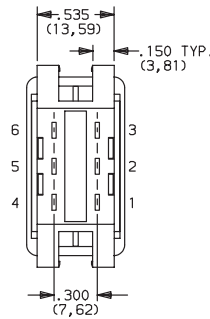
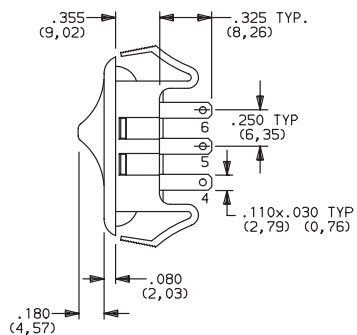
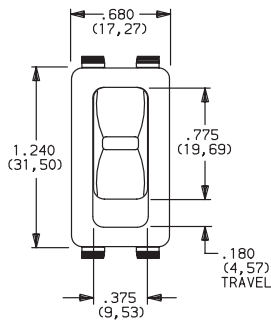

#### PANEL MOUNTING

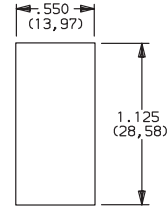

**PANEL THICKNESS:** .020 (0,57) - .200 (5,08)



S802C21S207Q  
DPDT

#### AVAILABLE WITH:

**Models:** S701, S702, S711, S712, S801 and S802  
**Terminations:** 04, 07, 54, 57, WC and WR  
**Actuators:** C1, C2, C3, CT and 03

OPTION CODE	TOP PLATE COLOR
<b>S2</b>	(STD.) BLACK
<b>S1</b>	WHITE
<b>S3</b>	RED
<b>ST</b>	BEIGE

**NOTE:** Housing top plate finish: matte. If no color is specified, black will be supplied.

# S Series Slide Switches



## TERMINATIONS

**03 (STD.) SOLDER LUG WITH HOLE**

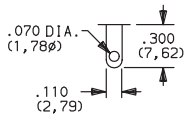

**01 SOLDER LUG WITH NOTCH**

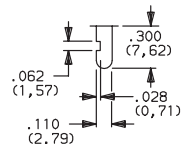

**02 PC THRU-HOLE**

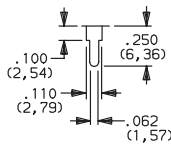

Recommended with 'MS' mounting style only.

**04 PC THRU-HOLE**

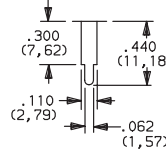

Recommended with double pole models only.

**07 QUICK CONNECT**

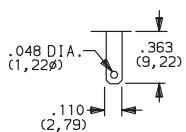

**08 PC THRU-HOLE**

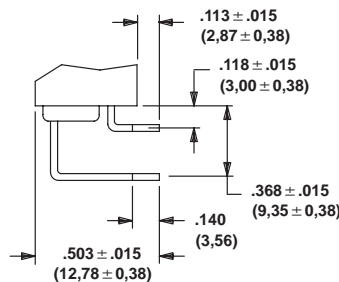

MS mounting style only.

**WC WIRE LEAD**

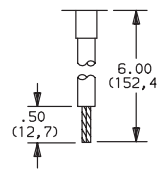

18 AWG wire for S1XX and S2XX models.  
16 AWG wire for all other models. Black wire standard, other colors and lengths available, consult Customer Service Center. UL style 1015.

### PC MOUNTING

02 & 04 terminations

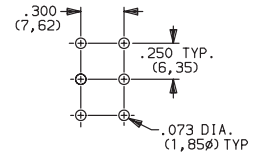

08 terminations with MS mounting style.

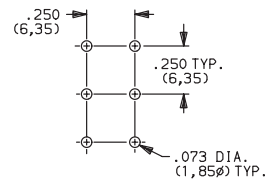

**NOTE:** All terminals on S1XX, S2XX, S5XX and S6XX models are .020 (0,51) thick; all terminals on S7XX and S8XX models are .031 (0,79) thick.

### REVERSING SWITCH OPTION

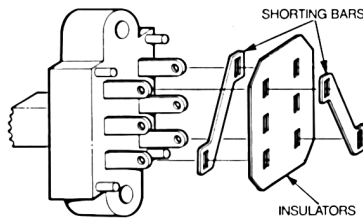

DPST and DPDT models are only available with two diagonal terminal jumper strips, providing reversing capability. Select desired termination option from chart.

### REVERSING SWITCH TERMINATION OPTIONS

OPTION CODE	DESCRIPTION
<b>51</b>	01 TERMINALS + REVERSING FEATURE
<b>52</b>	02 TERMINALS + REVERSING FEATURE
<b>53</b>	03 TERMINALS + REVERSING FEATURE
<b>54</b>	04 TERMINALS + REVERSING FEATURE
<b>57</b>	07 TERMINALS + REVERSING FEATURE
<b>WR</b>	WC TERMINALS + REVERSING FEATURE

## TOP PLATE MARKINGS

**NONE (STD.) NO MARKINGS**

**D ON-OFF**

**L ON**

**M ON-OFF**

**N RED RECTANGLE ON ONE END**

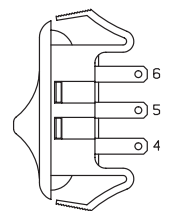
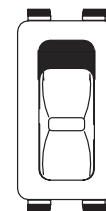
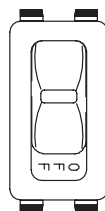
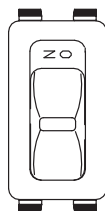
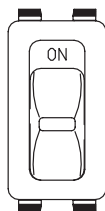
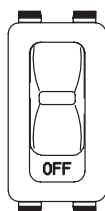
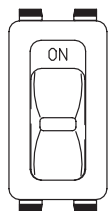
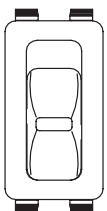

**NOTE:** Top plate markings are available with 'S1, S2, S3 and ST' mounting style only. The marking color on all top plates with marking options 'D, L and M' is white, standard. (except white top plates: marking color is black, standard). The marking color on all top plates with 'N' marking option is red, standard. Other marking colors are available, consult Customer Service Center.

**Note:** Orientation of actuator markings and terminals.



# S Series Slide Switches

## CONTACT MATERIAL

OPTION CODE	CONTACT AND TERMINAL MATERIAL	RATINGS	
<b>Q (STD.)</b>	SILVER <sup>2</sup>	POWER	S1XX, S2XX MODELS: 6 AMPS @ 125 V AC; 6 AMPS @ 250 V AC; 1 AMP @ 125 V DC (UL/CSA). S5XX, S6XX MODELS: 12 AMPS @ 125 V AC; 6 AMPS @ 250 V AC; 1 AMP @ 125 V DC (UL/CSA). S7XX, S8XX MODELS: 15 AMPS @ 125 V AC; 6 AMPS @ 250 V AC (UL/CSA).
<b>B</b>	GOLD <sup>1</sup>	LOW LEVEL / DRY CIRCUIT	0.4 VA MAX. @ 20 V AC OR DC max.
<b>G</b>	GOLD OVER SILVER <sup>3</sup>	LOW LEVEL / DRY CIRCUIT OR POWER	S1XX, S2XX MODELS: 0.4 VA MAX. @ 20 V AC OR DC MAX. OR 6 AMPS @ 125 V AC; 6 AMPS @ 250 V AC; 1 AMP @ 125 V DC (UL/CSA). S5XX, S6XX MODELS: 0.4 VA MAX. @ 20 V AC OR DC MAX. OR 12 AMPS @ 125 V AC; 6 AMPS @ 250 V AC; 1 AMP @ 125 V DC (UL/CSA). S7XX, S8XX MODELS: 0.4 VA MAX. @ 20 V AC OR DC MAX. OR 15 AMPS @ 125 V AC; 6 AMPS @ 250 V AC (UL/CSA).

CONTACT MATERIAL / APPLICATION RECOMMENDATIONS — SEE CHART, PAGE L-31.

<sup>1</sup> CONTACTS & TERMINALS: Copper, with gold plate over nickel plate.

<sup>2</sup> CONTACTS & TERMINALS: Copper, silver plated (standard with all termination options).

<sup>3</sup> CONTACTS & TERMINALS: Copper, with gold plate over nickel plate over silver plate.

All models  with all options when ordered with 'G' or 'Q' contact material.

**NOTE:** 'G' contact material is equivalent to both 'B' and 'Q' contact materials.

## SEAL

**NONE** (STD.) NO SEAL

**E** EPOXY SEAL

